

52220089	DATA SHEET	
Valid from: 03.07.2018	SKINTOP® BRUSH ADD-ON 24	

The SKINTOP® BRUSH ADD-ON 24 is an optimal, low impedance screen contacts for the SKINTOP® multiple cable entry. By the brush layout you get a reliable and permanent contact to the insert cable.
The mounting and demounting be made by screwing in to the control cabinet.



Material:

Frame: Aluminium
 Contact Brush: Wire made of Brass
 Distance sleeves: Aluminium
 Screws: Steel, nickel-plated
 Screw-nuts + washer: Steel, nickel-plated

Technical Features:

Connecting Screws: M4x1,0

Electrical Features:

Screening attenuation:

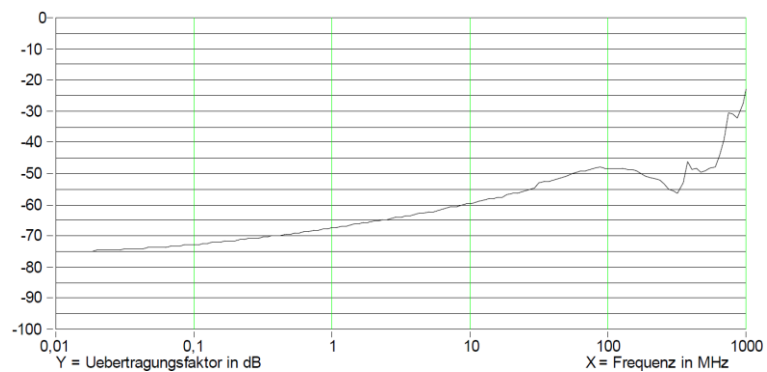

Attenuation:

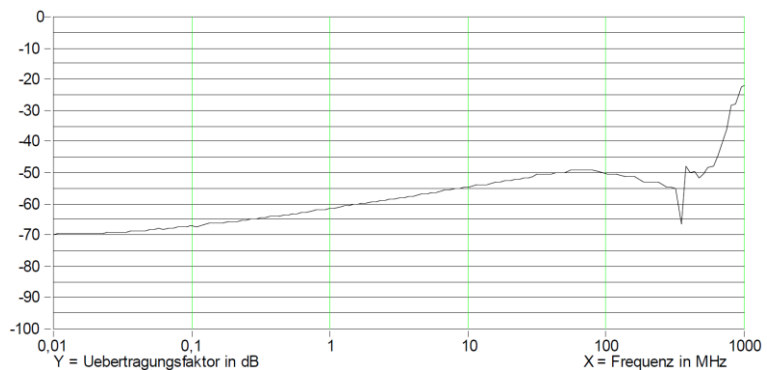

Contact resistance: 6,3-8 mΩ (50A / 50Hz) acc. to EN 60204-1
 Resistance: <0,03 Ω

Note:

For a perfect contact with metallic housings, a coating-free contact surface is recommended. Alternatively, contacting via earthing straps is possible.

Temperature range: -20°C up to +110°C

Norm Reference: Electrical contact following to EN 62444

Creator: M. Wegerer /PDP Released: DAMU1/PDP	Document: DB52220089EN Version: 02	Page 1 of 2
---	---------------------------------------	-------------

52220089	DATA SHEET	
Valid from: 03.07.2018	SKINTOP® BRUSH ADD-ON 24	

Contact resistance acc. to EN 60204-1

Suitable conduits:

SKINTOP® MULTI
SKINTOP® CUBE MULTI
SKINTOP® CUBE

SKINTOP® BRUSH ADD-ON 24

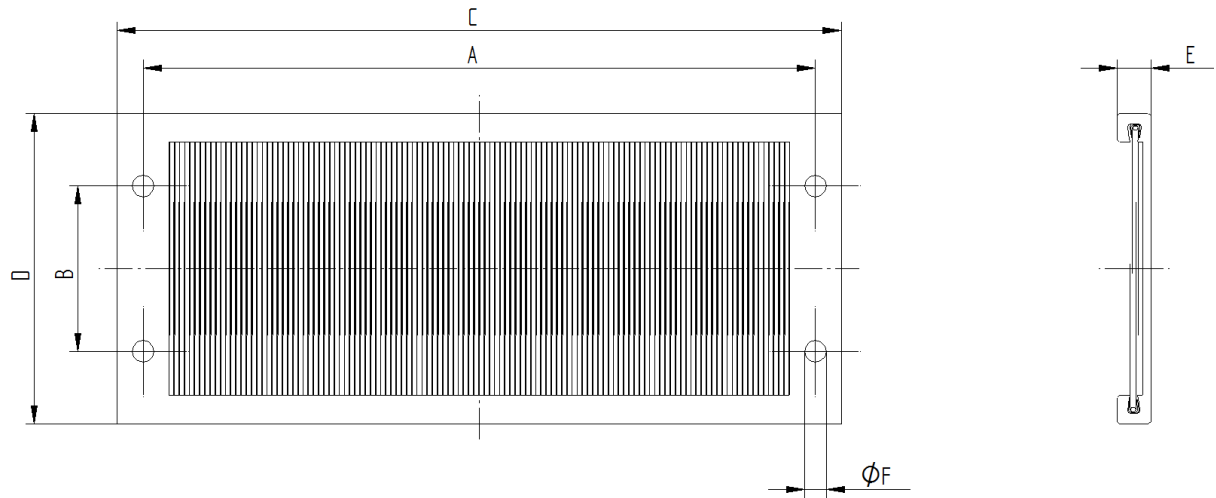

Dimension:

Part No.	A mm	B mm	C mm	D mm	E mm	F mm	Weight g
5222 0089	130	32	140	60	6,5	4,2	15

For more information please see our current catalogue. Please do not hesitate to contact our laboratory if there are any questions regarding resistance against aggressive agents and special oil.

Creator: M. Wegerer /PDP Released: DAMU1/PDP	Document: DB52220089EN Version: 02	Page 2 of 2
---	---------------------------------------	-------------